

# YK180XC

**Clean type: Extra small type**

Note. Built-to-order product. Contact us for the delivery period.

- Arm length 180mm
- Maximum payload 1kg

## Ordering method

**YK180XC - 100**

**RCX340-4**

Model	Z axis stroke	Cable length	Controller / Number of controllable axes	Safety standard	Option A (OP.A)	Option B (OP.B)	Option C (OP.C)	Option D (OP.D)	Option E (OP.E)	Absolute battery
	100: 100mm	3L: 3.5m 5L: 5m 10L: 10m								

Specify various controller setting items. RCX340 ▶ **P.636**

## Basic specifications

	X axis	Y axis	Z axis	R axis
<b>Axis specifications</b>				
Arm length (mm)	71	109	100	-
Rotation angle (°)	+/-120	+/-140	-	+/-360
<b>AC servo motor output (W)</b>	50	30	30	30
<b>Repeatability</b> <sup>Note 1</sup> (XYZ: mm) (R: °)	+/-0.01		+/-0.01	+/-0.004
<b>Maximum speed</b> (XYZ: m/sec) (R: °/sec)	3.3		0.7	1700
<b>Maximum payload (kg)</b>	1.0			
<b>Standard cycle time: with 0.1kg payload</b> <sup>Note 2</sup> (sec)	0.42			
<b>R-axis tolerable moment of inertia</b> <sup>Note 3</sup> (kgm <sup>2</sup> )	0.01			
<b>User wiring (sq × wires)</b>	0.1 × 8			
<b>User tubing (Outer diameter)</b>	φ3 × 2			
<b>Travel limit</b>	1.Soft limit, 2.Mechanical limit (X, Y, Z axis)			
<b>Robot cable length (m)</b>	Standard: 3.5 Option: 5, 10			
<b>Weight (kg) (Excluding robot cable)</b> <sup>Note 4</sup>	6.5			
<b>Robot cable weight</b>	1.5kg (3.5m) 2.1kg (5m) 4.2kg (10m)			
<b>Degree of cleanliness</b>	CLASS 10 (0.1 μm base)			
<b>Intake air (Nℓ/min)</b>	30			

Note 1. This is the value at a constant ambient temperature. (X,Y axes)

Note 2. When moving 25mm in vertical direction and 100mm in horizontal direction reciprocally.

Note 3. The acceleration coefficient is set automatically in accordance with the tip weight and R-axis moment of inertia settings.

Note 4. The total robot weight is the sum of the robot body weight and the cable weight.

## Controller

Controller	Power capacity (VA)	Operation method
RCX340	500	Programming / I/O point trace / Remote command / Operation using RS-232C communication

## YK180XC

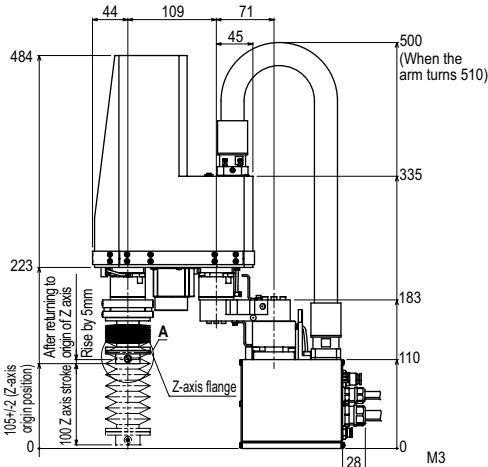
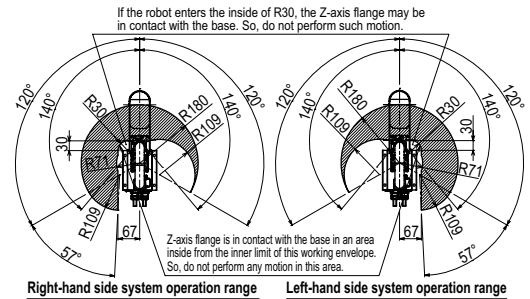
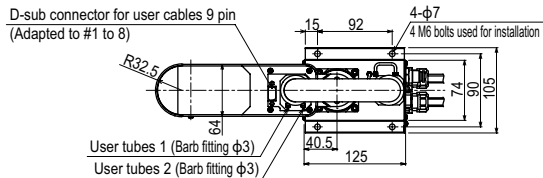

Right-hand side system operation range

Left-hand side system operation range

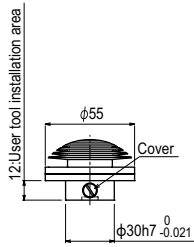

Details of A

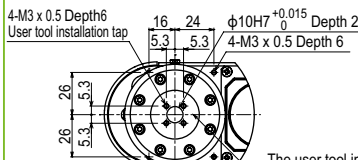

Details of B

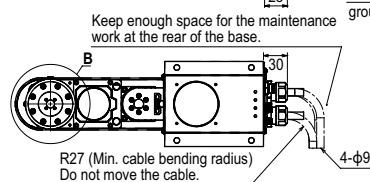

X-axis and Y-axis origin positions

Move counterclockwise in advance from the above position when performing origin return.

